



**BURNSIDE**

[ THE DIFFERENCE IS OUR PEOPLE ]

---

## Preliminary Design Plans Part 2

**Accessible formats and communication  
supports are available upon request:**

**York Region Transportation, Public Works**

Phone: 1-877-464-9675 ext. 75000

TTY: 1-866-512-6228

Email: [Transportation@york.ca](mailto:Transportation@york.ca)

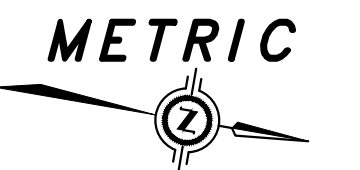

- NOTES**
- ALL NEW INTERSECTION LAYOUTS ARE BASED ON THE COMPLETED COLLECTOR ROADS EA. FINAL LANE CONFIGURATION IS SUBJECT TO DEVELOPMENT APPROVALS.
  - REFER TO TRCA EROSION AND SEDIMENT CONTROL GUIDE FOR URBAN CONSTRUCTION (2019) FOR THE DESIGN AND DESIGN ALTERATION OF ESC MEASURES.

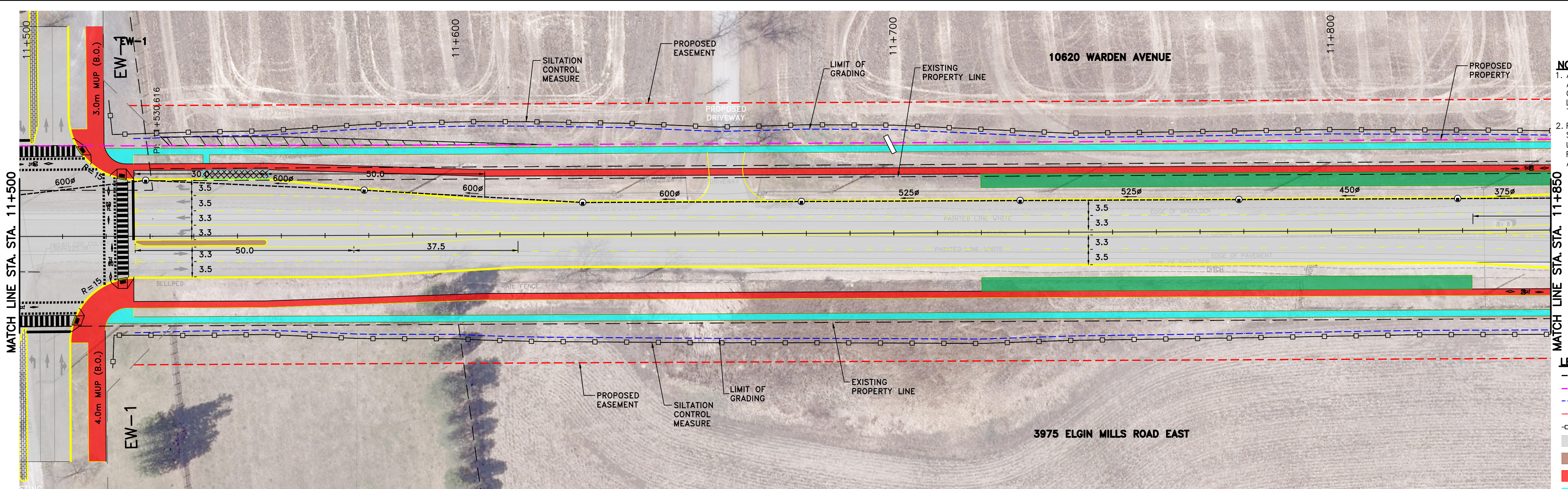

- LEGEND**
- EXIST. RIGHT OF WAY
  - PROP. RIGHT OF WAY
  - PROP. LIMIT OF GRADING
  - PROP. EASEMENT
  - SILTATION CONTROL MEASURE
  - ▭ PROP. ASPHALT ROAD
  - ▭ PROP. PAVER MEDIAN
  - ▭ CYCLE TRACK/MUP
  - ▭ SIDEWALK
  - ▭ LID
  - ▭ BUS PAD
  - ▭ ADD'L WIDENING AT INTERSECTION

**WARDEN AVENUE (Y.R.65)**

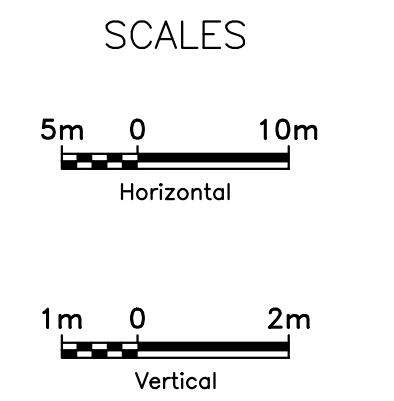
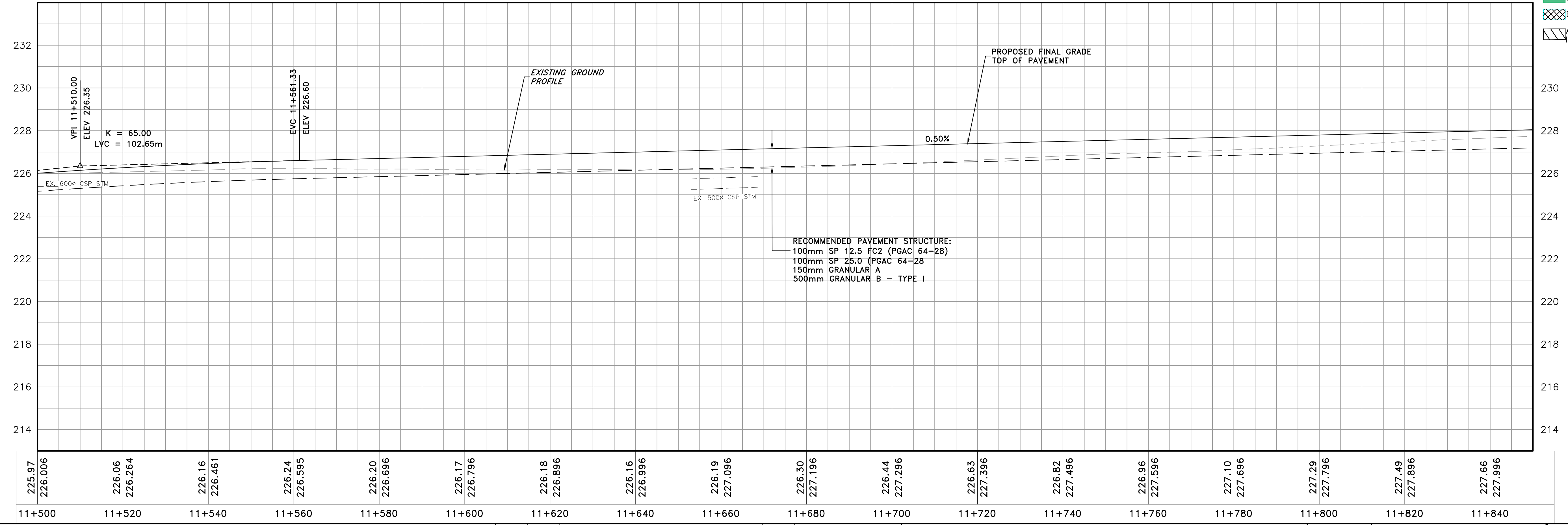

**NOTES:**  
 THE LOCATION OF UTILITIES IS APPROXIMATE ONLY. CONSULT THE RESPECTIVE MUNICIPAL AUTHORITIES AND UTILITY COMPANIES TO DETERMINE THE EXACT LOCATION OF THEIR UTILITIES. THE CONTRACTOR SHALL VERIFY THE LOCATION OF UTILITIES AND SHALL ADEQUATELY PROTECT AND SUPPORT THEM DURING CONSTRUCTION.

- STORM SEWERS:**
- INVERT ELEVATIONS SHOWN ARE AT CENTRE-LINE OF CATCHBASIN OR MANHOLE.
  - PIPE LENGTHS SHOWN ARE CENTRE-LINE TO CENTRE-LINE OF CATCHBASIN OR MAINTENANCE HOLE.
  - OFFSETS SHOWN ARE TO CENTRE OF CATCHBASIN OR MAINTENANCE COVER.

No.	DATE	REVISIONS	BY

**BURNSIDE**  
 R.J. Burnside & Associates Limited  
 6990 Creditview Road, Unit 2  
 Mississauga, Ontario, L3N 8R9  
 telephone (905) 821-1800  
 fax (905) 821-1809  
 web www.rjburnside.com

**York Region** Transportation Services

**WARDEN AVENUE (Y.R.65)**  
 NEW CONSTRUCTION  
 STA. 11+500 TO STA. 11+850

DESIGN R.B.  
 DRAWN R.B.  
 CHECKED J.A.

DWG. NO. NC-PAP-06  
 CONT. NO. 2022-XXX  
 SHEET NO. 6

FILE: \\monty\Shared Work Areas\052314 - Warden-Kennedy EA\03 ProductionDwg\Warden Ave\052314 - PLAN PROFILE-WARD.dwg

FILE: \\monty\Shared Work Areas\052314 - Warden-Kennedy EA\03 ProductionDwg\Warden Ave\052314 - PLAN PROFILE-WARD.dwg

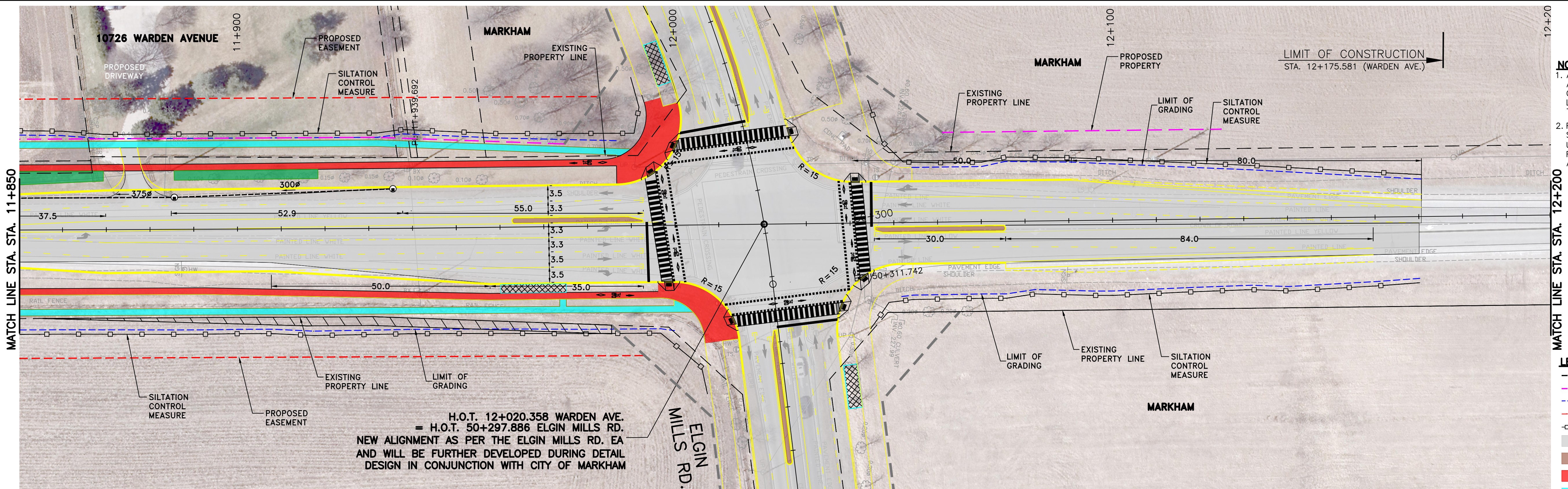

H.O.T. 12+020.358 WARDEN AVE.  
= H.O.T. 50+297.886 ELGIN MILLS RD.  
NEW ALIGNMENT AS PER THE ELGIN MILLS RD. EA  
AND WILL BE FURTHER DEVELOPED DURING DETAIL  
DESIGN IN CONJUNCTION WITH CITY OF MARKHAM

WARDEN AVENUE (Y.R.65)

**METRIC**

**NOTES**

- ALL NEW INTERSECTION LAYOUTS ARE BASED ON THE COMPLETED COLLECTOR ROADS EA. FINAL LANE CONFIGURATION IS SUBJECT TO DEVELOPMENT APPROVALS.
- REFER TO TRCA EROSION AND SEDIMENT CONTROL GUIDE FOR URBAN CONSTRUCTION (2019) FOR THE DESIGN AND DESIGN ALTERATION OF ESC MEASURES.

- LEGEND**
- EXIST. RIGHT OF WAY
  - PROP. RIGHT OF WAY
  - PROP. LIMIT OF GRADING
  - PROP. EASEMENT
  - SILTATION CONTROL MEASURE
  - PROP. ASPHALT ROAD
  - PROP. PAVER MEDIAN
  - CYCLE TRACK/MUP
  - SIDEWALK
  - LID
  - BUS PAD
  - ADD'L WIDENING AT INTERSECTION

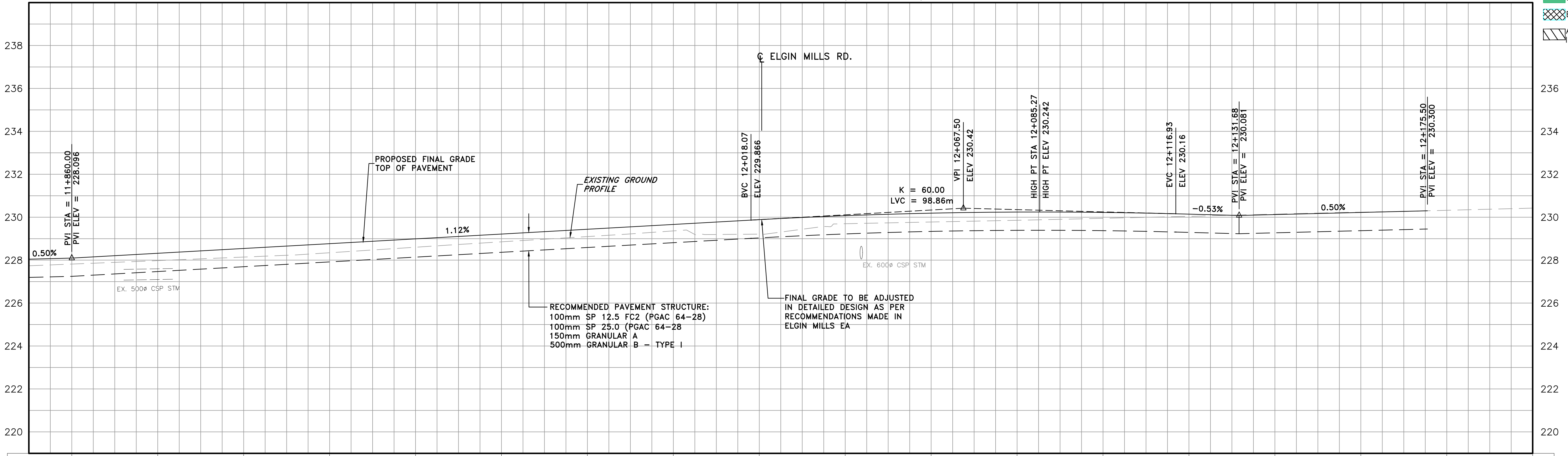

RECOMMENDED PAVEMENT STRUCTURE:  
100mm SP 12.5 FC2 (PGAC 64-28)  
100mm SP 25.0 (PGAC 64-28)  
150mm GRANULAR A  
500mm GRANULAR B - TYPE I

FINAL GRADE TO BE ADJUSTED  
IN DETAILED DESIGN AS PER  
RECOMMENDATIONS MADE IN  
ELGIN MILLS EA

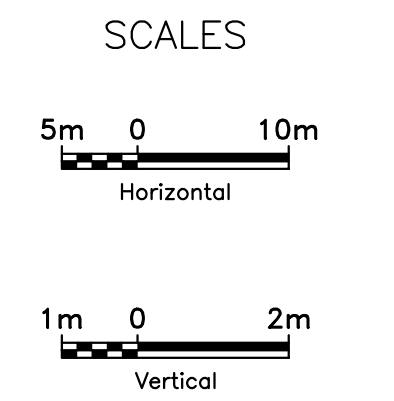

227.82 228.096	227.98 228.320	228.14 228.544	228.34 228.768	228.60 228.992	228.85 229.216	229.10 229.440	229.36 229.664	229.70 230.071	229.78 230.189	229.86 230.240	229.95 230.224	230.04 230.143	230.14 230.122	230.23 230.222	230.32	230.42	
11+860	11+880	11+900	11+920	11+940	11+960	11+980	12+000	12+020	12+040	12+060	12+080	12+100	12+120	12+140	12+160	12+180	12+200

**NOTES:**  
THE LOCATION OF UTILITIES IS APPROXIMATE ONLY. CONSULT THE RESPECTIVE MUNICIPAL AUTHORITIES AND UTILITY COMPANIES TO DETERMINE THE EXACT LOCATION OF THEIR UTILITIES. THE CONTRACTOR SHALL VERIFY THE LOCATION OF UTILITIES AND SHALL ADEQUATELY PROTECT AND SUPPORT THEM DURING CONSTRUCTION.

**STORM SEWERS:**

- INVERT ELEVATIONS SHOWN ARE AT CENTRE-LINE OF CATCHBASIN OR MANHOLE.
- PIPE LENGTHS SHOWN ARE CENTRE-LINE TO CENTRE-LINE OF CATCHBASIN OR MAINTENANCE HOLE.
- OFFSETS SHOWN ARE TO CENTRE OF CATCHBASIN OR MAINTENANCE COVER.

No.	DATE	REVISIONS	BY

**BURNSIDE**  
R.J. Burnside & Associates Limited  
6990 Creditview Road, Unit 2  
Mississauga, Ontario, L5N 8R9  
telephone (905) 821-1800  
fax (905) 821-1809  
web www.rjburnside.com

**York Region** Transportation Services

**WARDEN AVENUE (Y.R.65)**  
NEW CONSTRUCTION  
STA. 11+850 TO STA. 12+200

DESIGN R.B.  
DRAWN R.B.  
CHECKED J.A.

DWG. NO. NC-PAP-07  
CONT. NO. 2022-XXX  
SHEET NO. 7

FILE: \\monty\Shared Work Areas\052314 - Warden-Kennedy EA\03 ProductionDwg\Warden Ave\052314 - TXS-WARD.dwg

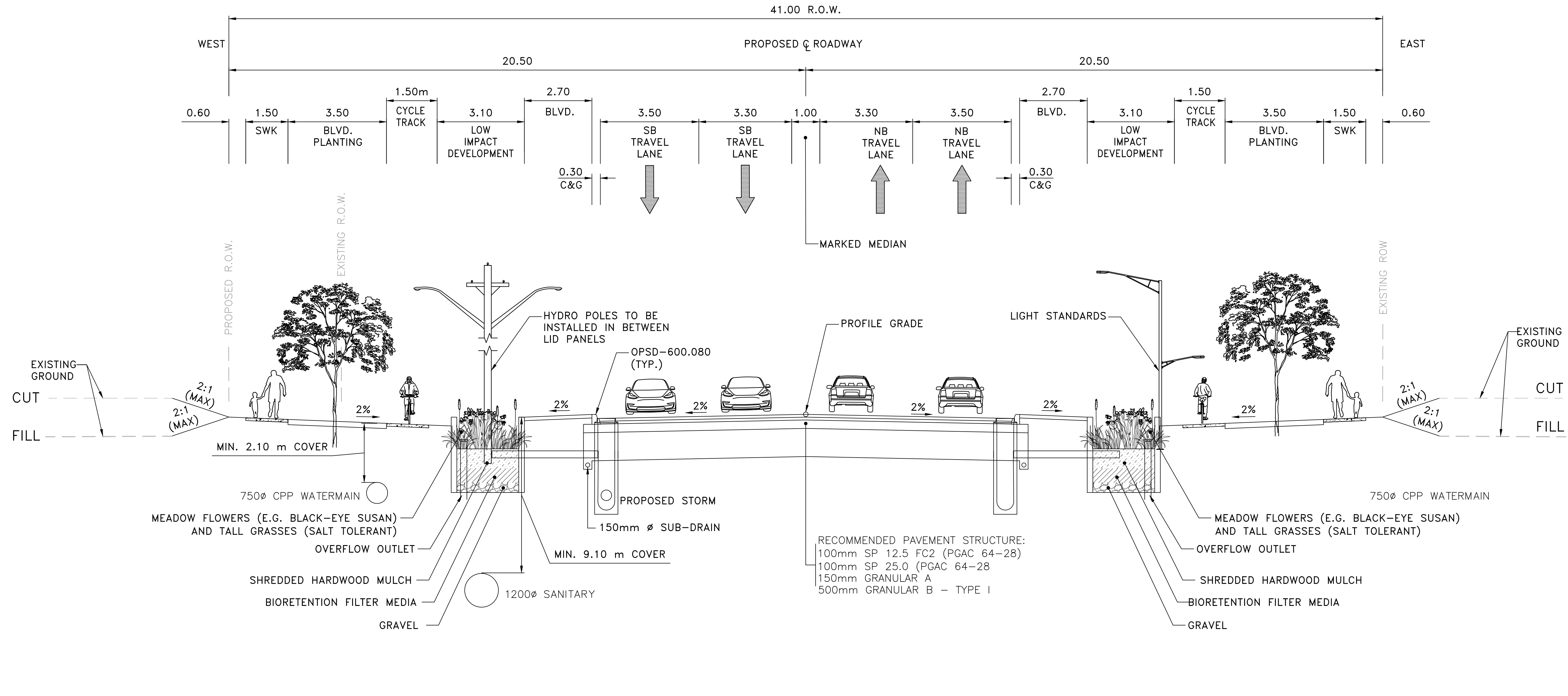

TYPICAL 4-LANE CROSS SECTION (WITH MARKED MEDIAN ISLAND)  
N.T.S.

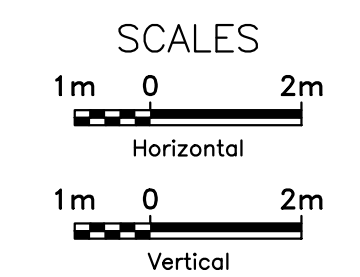

NOTES:  
THE LOCATION OF UTILITIES IS APPROXIMATE ONLY. CONSULT THE RESPECTIVE MUNICIPAL AUTHORITIES AND UTILITY COMPANIES TO DETERMINE THE EXACT LOCATION OF THEIR UTILITIES. THE CONTRACTOR SHALL VERIFY THE LOCATION OF UTILITIES AND SHALL ADEQUATELY PROTECT AND SUPPORT THEM DURING CONSTRUCTION.

- STORM SEWERS:  
1. INVERT ELEVATIONS SHOWN ARE AT CENTRE-LINE OF CATCHBASIN OR MANHOLE.  
2. PIPE LENGTHS SHOWN ARE CENTRE-LINE TO CENTRE-LINE OF CATCHBASIN OR MAINTENANCE HOLE.  
3. OFFSETS SHOWN ARE TO CENTRE OF CATCHBASIN OR MAINTENANCE COVER.

No.	DATE	REVISIONS	BY
#	#	#	#

**BURNSIDE**  
R.J. Burnside & Associates Limited  
6990 Creditview Road, Unit 2  
Mississauga, Ontario, L3N 8R9  
telephone (905) 821-1800  
fax (905) 821-1809  
web www.rjburnside.com

**York Region** Transportation Services

DESIGN R.B.	<b>WARDEN AVENUE EA 4-LANE (WITH MARKED MEDIAN ISLAND) TYPICAL CROSS SECTION PREFERRED DESIGN YR-RDGL - DS-104</b>	DWG. NO. NC-TXS-01
DRAWN R.B.		CONT. NO. 2022-XXX
CHECKED J.A.		SHEET NO. 8

METRIC

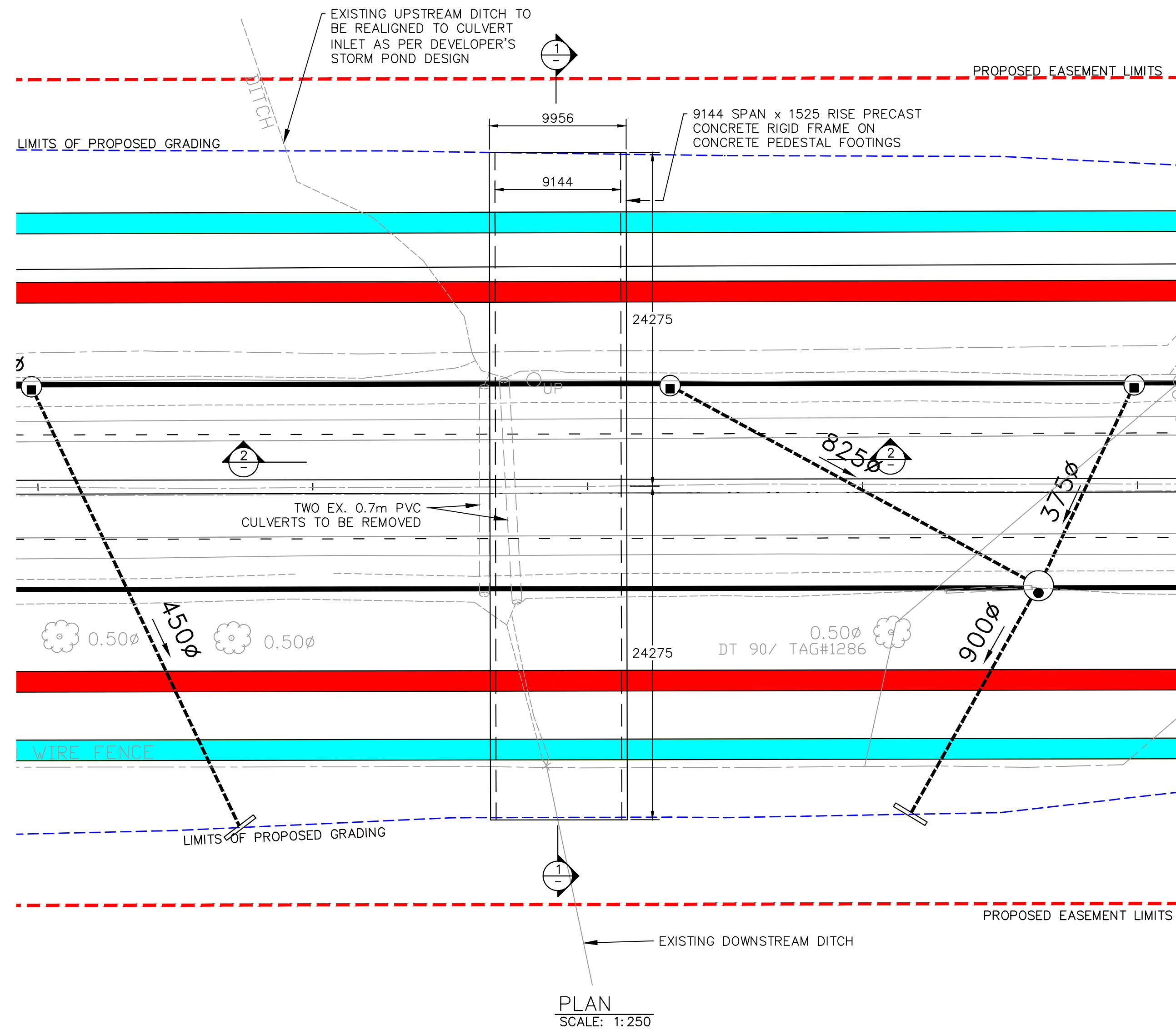
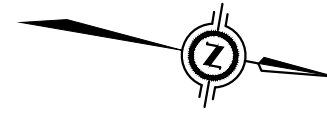

GENERAL NOTES:

- DESIGNED TO CANADIAN HIGHWAY BRIDGE DESIGN CODE (CHBDC) CSA S6:19 TO SUPPLEMENT 2, LIVE LOAD TRUCK TO CL-625-ONT.
- CONCRETE SHALL BE EXPOSURE CLASS C-1 WITH A MINIMUM SPECIFIED COMPRESSIVE STRENGTH OF 35 MPa AT 56 DAYS.
- CLEAR COVER TO REINFORCING STEEL
 

FOOTINGS	BOTTOM	100 ± 25	REMAINDER	70 ± 20
DECK	TOP	70 ± 20		
	BOTTOM	50 ± 10		
	REMAINDER	70 ± 20	UNLESS OTHERWISE NOTED	
- REINFORCING BARS:
  - REINFORCING STEEL (BLACK) SHALL BE GRADE 400W UNLESS OTHERWISE SPECIFIED.
  - STAINLESS REINFORCING STEEL SHALL BE TYPE 316LN, DUPLEX 2205 AND HAVE MINIMUM YIELD STRENGTH OF 500 MPa, UNLESS OTHERWISE SPECIFIED.
  - BAR MARKS WITH PREFIX 'S' DENOTE STAINLESS STEEL BARS.
  - ALL LAP LENGTHS SHALL BE CONSIDERED TENSION CLASS 'B' UNLESS NOTED OTHERWISE.
  - NOT ALL LAP SPLICES ARE SHOWN ON THE DRAWINGS. WHERE BARS ARE SHOWN AS CONTINUOUS, LAP SPLICES ARE REQUIRED TO SUIT THE ACTUAL AVAILABLE LENGTHS OF THE REBAR. THE CONTRACTOR MAY PROVIDE LAPS NOT REPRESENTED IN THE DRAWINGS, SUBJECT TO THE APPROVAL OF THE ENGINEER.
  - WHERE LAP SPLICES ARE PROPOSED BY THE CONTRACTOR, THE LOCATIONS SHALL BE SUCH THAT THEY LEAST IMPACT THE STRUCTURE.
  - BAR HOOKS SHALL HAVE STANDARD HOOK DIMENSIONS USING MINIMUM BEND DIAMETERS, WHILE STIRRUPS AND TIES SHALL HAVE MINIMUM HOOK DIMENSIONS. ALL HOOKS SHALL BE IN ACCORDANCE WITH THE STRUCTURAL STANDARD DRAWING SS12-1, (AVAILABLE UPON REQUEST) OR THE REINFORCING STEEL INSTITUTE OF ONTARIO OR CANADA (RSIO or RSIC), UNLESS INDICATED OTHERWISE.
- CONSTRUCTION NOTES
  - BACKFILL SHALL BE PLACED SIMULTANEOUSLY BEHIND BOTH ABUTMENTS KEEPING THE HEIGHT OF THE BACKFILL APPROXIMATELY THE SAME. AT NO TIME SHALL THE DIFFERENCE IN ELEVATION BE GREATER THAN 500mm.
  - THE CONTRACTOR SHALL CONFIRM ALL DIMENSIONS AND DETAILS BEFORE STARTING WORK.
  - THE CONTRACTOR IS RESPONSIBLE FOR THE VERIFICATION AND PROTECTION OF ALL EXISTING UTILITIES, SERVICES, STRUCTURES, ROADWAYS, ETC. DURING CONSTRUCTION.
  - CHAMFERS MAY OR MAY NOT BE SHOWN ON DRAWINGS. ALL EXPOSED CORNERS TO HAVE 25mm x 25mm CHAMFERS UNLESS NOTED OTHERWISE. CONSTRUCTION JOINTS TO HAVE A 20mm x 20mm CHAMFER.

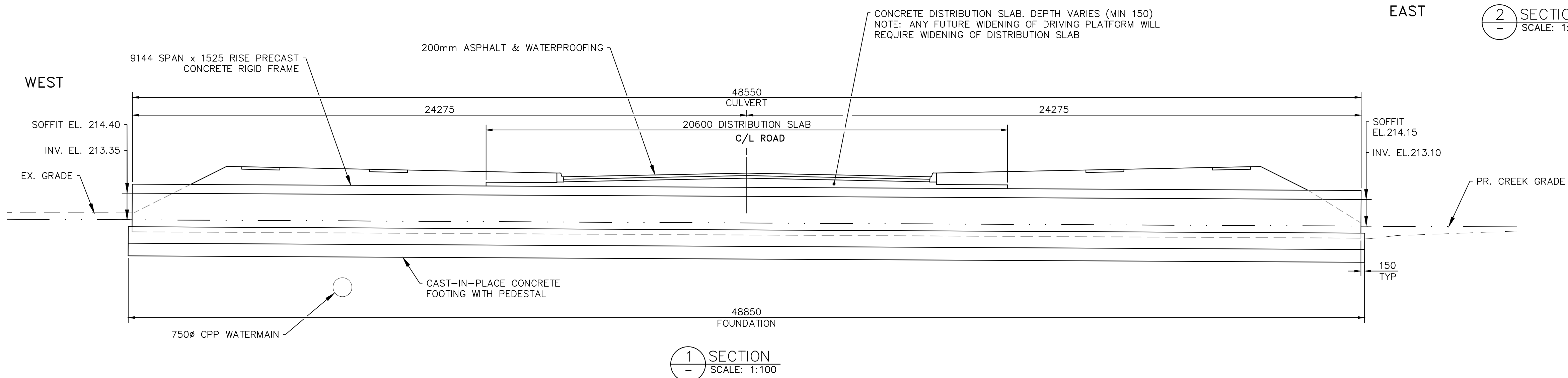
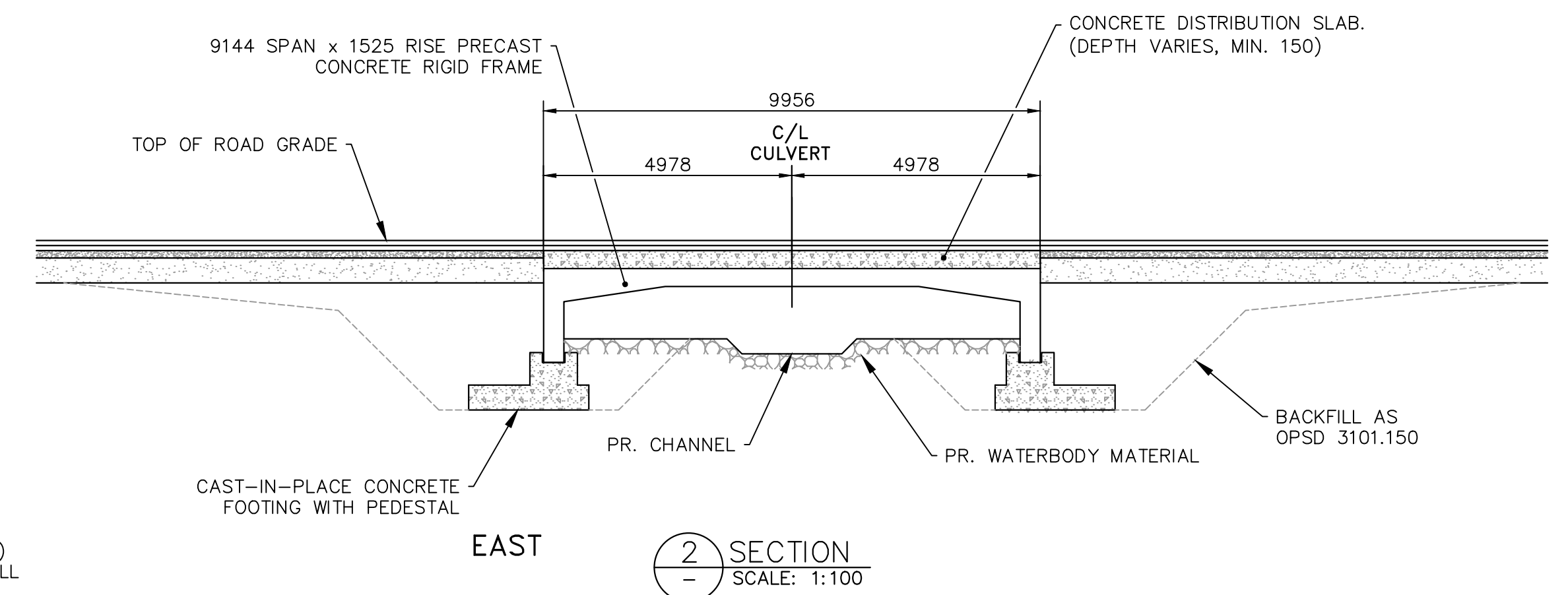

NOTES:  
THE LOCATION OF UTILITIES IS APPROXIMATE ONLY. CONSULT THE RESPECTIVE MUNICIPAL AUTHORITIES AND UTILITY COMPANIES TO DETERMINE THE EXACT LOCATION OF THEIR UTILITIES. THE CONTRACTOR SHALL VERIFY THE LOCATION OF UTILITIES AND SHALL ADEQUATELY PROTECT AND SUPPORT THEM DURING CONSTRUCTION.

STORM SEWERS:  
1. INVERT ELEVATIONS SHOWN ARE AT CENTRE-LINE OF CATCHBASIN OR MANHOLE.  
2. PIPE LENGTHS SHOWN ARE CENTRE-LINE TO CENTRE-LINE OF CATCHBASIN OR MAINTENANCE HOLE.  
3. OFFSETS SHOWN ARE TO CENTRE OF CATCHBASIN OR MAINTENANCE COVER.

No.	DATE	REVISIONS	BY
#	#	#	#

**BURNSIDE**  
R.J. Burnside & Associates Limited  
6990 Creditview Road, Unit 2  
Mississauga, Ontario, L3N 8R9  
telephone (905) 821-1800  
fax (905) 821-1809  
web www.rjburnside.com



Transportation Services

DESIGN A.D.  
DRAWN N.P./R.B.  
CHECKED A.D./J.A.

**WARDEN AVENUE (Y.R.65)**  
GENERAL ARRANGEMENT PLAN

DWG. NO. NC-GA  
CONT. NO. 2022-XXX  
SHEET NO. 9